



**Planning, Development, &
Transportation Department**

Planning Division
305 Chestnut Street
PO Box 1810
Wilmington, NC 28402-1810

910 254-0900
910 341-3264 fax
wilmingtonnc.gov
Dial 711 TTY/Voice

March 1, 2022

Kathryn Espinoza
McKim & Creed
243 N. Front Street
Wilmington, NC 28401

RE: Center Point, located at 1531 Eastwood Road

I have attached a copy of the early clearing and grading release. Please make note of the conditions for the release as they appear on the attached release letter. These conditions must be followed and met in order for the construction to be approved. ***Prior to beginning grading on the site, you must have a pre-construction meeting between City staff and the project's representatives. Any violation of this condition will result in an immediate stop work order and other civil penalties.***

All grading on the site must be in accordance with New Hanover County erosion control standards and the erosion control plan approved by New Hanover County and the City of Wilmington. Any trees and areas designated to be saved or protected must be properly barricaded and/or marked throughout construction. In addition please be aware that no construction of buildings, structures, walls, etc. may begin until the City of Wilmington's Technical Review Committee has approved the final plans and final construction release is granted.

Please contact our office at 254-0900 if you have any questions or concerns regarding this information and to schedule a pre-construction meeting with City staff. The City thanks you for your investment in our community and looks forward to working with you towards construction of a quality development project.

Sincerely,

Brian Chambers, AICP
Senior Planner



Planning, Development, & Transportation Department
 Planning Division
 305 Chestnut Street
 PO Box 1810
 Wilmington, NC 28402-1810

910 254-0900
 910 341-3264 fax
 wilmingtonnc.gov
 Dial 711 TTY/Voice

TRANSMITTAL LETTER

TO: Traci Lunceford, Zoning Inspector
 DATE: February 25, 2022
 SUBJECT: Center Point Project No. 2021027
RELEASE FOR CLEARING AND GRADING PURPOSES ONLY
 Plans Sealed as of 2/21/22

The following items are being sent to you via this package.

QUAN.	DWG./NO.	DESCRIPTION
1	Dated 2/24/22	CenterPoint EGR Plans
1	Dated 2/9/22	City Tree Removal Permit TPP-22-115
1	Dated 2/17/22	NHC Erosion Control #GP 21-21
1	Dated 11/19/02	Policy on the Release of Projects for the Purpose of Clearing and Grading

REMARKS: CenterPoint, located at 1531 Eastwood Road, is hereby conditionally released **for clearing and grading purposes only**. The following conditions must be satisfied as part of this release:

1. **A PRE-CONSTRUCTION MEETING MUST BE HELD BETWEEN THE SITE CONTRACTOR AND CITY STAFF PRIOR TO ANY GRADING BEGINNING ON THE SITE. FAILURE TO COMPLY WILL RESULT IN IMMEDIATE CIVIL PENALTIES.**
2. **NO CONSTRUCTION OF ANY BUILDING, STRUCTURE, WALL, UTILITIES, INFRASTRUCTURE ETC. OF ANY KIND, INCLUDING FOOTINGS AND BUILDING SLABS, WILL BE PERMITTED UNTIL THE TECHNICAL REVIEW COMMITTEE HAS APPROVED THE FINAL CONSTRUCTION RELEASE.**
3. **ANY TREES AND/OR AREA DESIGNATED TO BE SAVED MUST BE PROPERLY BARRICADED OR MARKED WITH FENCING AND PROTECTED THROUGHOUT CONSTRUCTION TO INSURE THAT NO CLEARING AND GRADING WILL OCCUR IN THOSE AREAS.**
4. **THIS GRADING RELEASE IS GIVEN IN ACCORDANCE WITH THE EROSION CONTROL PLAN APPROVED BY NEW HANOVER COUNTY.**
5. **IF THE CONDITIONS LISTED ABOVE ARE VIOLATED; A STOP WORK ORDER WILL BE ISSUED.**
6. **THE DEVELOPER ASSUMES ALL RISKS AND PENALTIES WITH ANY DELAY OR STOP WORK ORDER ASSOCIATED WITH THE VIOLATION OF THIS RELEASE. BY SIGNING THIS, THE DEVELOPER ACKNOWLEDGES THE CONDITIONS OF THIS RELEASE AND ASSUMES ALL RESPONSIBILITIES AND RISKS ASSOCIATED WITH**

IT. THE CITY OF WILMINGTON WILL NOT BE HELD LIABLE FOR ANY COSTS ASSOCIATED WITH THE CLEARING AND GRADING RELEASE.

Brian Chambers

Signature: _____

Brian Chambers, AICP
Senior Planner

[Handwritten Signature]

Signature: _____

Owner / Applicant

Copy: Kathryn Espinoza, PE	Applicant (email only)
Bret Russell	Construction Manager
Rob Gordon	Engineering (email only)
Jim Quinn	Stormwater Specialist (email only)
Aaron Reese	Urban Forestry (email only)
Rich Christensen	Engineering (email only)
Eric Seidel	Engineering (email only)
Trent Butler	Engineering (email only)
Chris Elrod	Wilmington Fire Department (e-mail only)
Chris Walker	Wilmington Fire Department (e-mail only)
Brian Blackmon	Surveyor (e-mail only)
Jim Sahlie	GIS Addressing (e-mail only)
Bill McDow	Traffic Engineering (e-mail only)
Mitesh Baxi	Traffic Engineering (e-mail only)
Denys Vielkanowitz	Traffic Engineering (e-mail only)
Bernice Johnson	CFPUA (e-mail letter only)
Beth Easley Wetherill	NHC Erosion Control (e-mail only)
Michelle Hutchinson	GIS Engineer (e-mail only)
Amy Beatty	Community Services (e-mail only)
Ron McMillan	Community Services (e-mail only)
Joan Mancuso	City Zoning (email only)
Catherine Meyer	City Zoning (email only)
Shawn Evans	City Attorney's Office (email only)
Courtney Salgado	City Attorney's Office (email only)
Joseph Wurzel	NC DOT (email only)
Nick Drees	NC DOT (email only)
Jon Roan	NC DOT (email only)
Ben Hughes	NC DOT (email only)

File: CenterPoint

Project No. 2021027



Department of Planning, Development and Transportation
 Planning Division
 305 Chestnut Street
 PO Box 1810
 Wilmington, NC 28402-1810

910 254-0900
 910 341-3264 fax
 www.wilmingtonnc.gov
 Dial 711 TTY/Voice

APPROVED: X DENIED: _____

PERMIT #: TPP-22-115

Application for Tree Removal Permit

Name of Applicant: Centre Pointe, LLC Phone: 910-239-5590 Date: 04/28/2021

Name of Property Owner: Centre Pointe, LLC Phone: _____

Property Owner Address: 1131-B Military Cutoff Road, Wilmington NC 28405

Email address for permit to be sent: jason@swainassociates.com cc: claude@swainassociates.com; mary@swainassociates.com

Address of Proposed Tree Removal: East of Eastwood Road and Cavalier Drive intersection

Description and location of tree(s) to be removed & reason for removal: **(provide attachment if necessary and tag tree(s) on site)**

1. See attached

2. _____

3. _____ Trees being removed as part of the CenterPoint mixed use development. Trees within right of ways, non-municipal easements and SCMs are designated as essential site improvements and mitigation of regulated trees is not required. See attached lists, calculations and plans.

I, Kathryn Espinoza, PE, certify that the property owner has given me permission to apply for this permit on his/her behalf.

Applicant Signature: _____ Date: 4-28-21

*****FOR OFFICIAL USE ONLY*****

Reviewed by: B. Chambers Date: 2/9/22

Remarks: _____

ALL WORK MUST BE IN COMPLIANCE WITH THE CITY LAND DEVELOPMENT CODE, ARTICLE 8, LANDSCAPING AND TREE PRESERVATION

NEW CONSTRUCTION: _____ EXPANSION: _____ OTHER: _____ PAID: \$150.00 Paid 4/29/21

Tree preservation permit fees

Less than 1 acre	\$25.00
1-5 acres	\$50.00
5-10 acres	\$100.00
Greater than 10 acres	\$150.00

IF MITIGATION IS REQUIRED, CONTACT THE ZONING DEPARTMENT AT (910)254-0900 TO DISCUSS A PLANTING SCHEDULE

Application can be mailed, emailed to: zoning@wilmingtonnc.gov or dropped off at our office.

Tree Removal and Mitigation Calculations
CenterPoint (01421-0012)

# of Protected Trees to be Removed			
Regulated*			
# of Regulated Trees removed exempt due to Essential Site Improvements			583
Regulated			
Trees requiring mitigation			
		Minimum	Quantity
	Hardwoods	8"	0
	Conifer	12"	0
	Flowering Trees & American Holly	4"	0
	# of Regulated Trees removed requiring mitigation		0
Significant			
		Minimum Caliper	Quantity removed
	Hardwoods, Long Leaf Pine, Pocosin (Pond) Pine, Black Pine, Non-Pine Conifer*	24"	5
	All other Pines	32"	2
	Flowering Trees & American Holly	8"	6
	Total Removed =		13
*60" Oak referenced on Tree Removal list not included in mitigation calculations at this time			

Mitigation Tree Calculation			
Regulated Trees for Mitigation			
Cedar	(DBH * 75%)	/ 3 =	.0 Trees
Gum	(DBH * 75%)	/ 3 =	Trees
Hickory	(DBH * 75%)	/ 3 =	Trees
Holly	(DBH * 100%)	/ 3 =	Trees
Magnolia	(DBH * 50%)	/ 3 =	Trees
Oak	(DBH * 100%)	/ 3 =	Trees
Pine	(DBH * 50%)	/ 3 =	Trees
Total mitigation trees from Regulated Tree removal:			Trees

Significant Trees for Mitigation			
Cedar	(0 DBH *2* 75%)	/ 3 =	0 Trees
Gum	(0 DBH *2* 75%)	/ 3 =	0 Trees
Hickory	(0 DBH *2* 75%)	/ 3 =	0 Trees
Holly	(0 DBH *2* 100%)	/ 3 =	0 Trees
Magnolia	(104 DBH *2* 100%)	/ 3 =	69 Trees
Oak	(100 DBH *2* 100%)	/ 3 =	67 Trees
Pine	(70 DBH *2* 50%)	/ 3 =	23 Trees
Total mitigation trees from Significant Tree removal:			159 Trees

TOTAL MITIGATION REQUIRED =	159 Trees
------------------------------------	------------------

CenterPoint
Tree Removal

	COUNT
REGULATED*	583
REGULATED	0
SIGNIFICANT	13
UNPROTECTED	34
TOTAL REMOVED	630

*EXEMPT FROM MITIGATION DUE TO LOCATION WITHIN ESSENTIAL SITE IMPROVEMENTS

TREES TO BE REMOVED LOCATED WITHIN ESSENTIAL SITE IMPROVEMENTS (REGULATED TREES EXEMPT FROM MITIGATION)						
POINT NUMBER	EASTING	NORTHING	ELEVATION	TYPE	DIAMETER	STATUS
2686	177074.82	2352786.125	29.801	CED	8	UNPROTECTED
2688	177024.988	2352880.23	30.43	CED	8	UNPROTECTED
2004	177885.459	2353684.284	40.887	CED	8	UNPROTECTED
2005	177888.664	2353757.032	33.842	CED	8	UNPROTECTED
2024	177882.195	2353531.176	30.815	CED	8	UNPROTECTED
2025	177884.973	2353572.331	34.737	CED	8	UNPROTECTED
2027	177885.071	2353610.427	32.87	CED	8	UNPROTECTED
2029	177886.166	2353628.738	29.029	CED	8	UNPROTECTED
2096	177880.399	2353395.37	27.64	CED	8	UNPROTECTED
2108	177869.53	2353202.879	28.557	CED	8	UNPROTECTED
2111	177872.396	2353253.659	28.086	CED	8	UNPROTECTED
2113	177871.995	2353266.11	30.236	CED	8	UNPROTECTED
2114	177872.93	2353271.862	29.174	CED	8	UNPROTECTED
2115	177872.788	2353278.287	28.734	CED	8	UNPROTECTED
2161	177870.157	2353055.493	30.983	CED	8	UNPROTECTED
2599	176824.811	2353159.296	28.706	CED	10	UNPROTECTED
2600	176834.549	2353092.407	28.629	CED	10	UNPROTECTED
2601	176855.128	2353103.15	31.336	CED	10	UNPROTECTED
2031	177885.642	2353647.418	30.296	CED	10	UNPROTECTED
2094	177878.556	2353370.791	30.614	CED	10	UNPROTECTED
2095	177879.794	2353388.393	32.995	CED	10	UNPROTECTED
2097	177882.192	2353418.89	29.964	CED	10	UNPROTECTED
2098	177881.578	2353424.548	28.346	CED	10	UNPROTECTED
2137	177870.288	2353146.033	28.88	CED	10	UNPROTECTED
2631	177037.552	2353064.006	39.052	CED	10	UNPROTECTED
2739	177209.669	2352906.946	25.403	CED	10	UNPROTECTED
2740	177215.3786	2352896.595	25.394	CED	10	UNPROTECTED
2741	177221.7165	2352885.347	25.384	CED	10	UNPROTECTED
2742	177226.2806	2352875.788	25.376	CED	10	UNPROTECTED
2743	177230.8438	2352868.26	25.35	CED	10	UNPROTECTED

2744	177234.6469	2352861.41	25.346	CED	10	UNPROTECTED
2745	177238.2812	2352854.475	25.345	CED	10	UNPROTECTED
2746	177241.844	2352848.396	25.34	CED	10	UNPROTECTED
2752	177251.142	2352844.687	35.477	CED	10	UNPROTECTED
88	176995.335	2353029.053	31.818	CED	12	REGULATED*
2071	177881.438	2353530.536	31.605	CED	12	REGULATED*
2117	177874.106	2353306.621	30.456	CED	12	REGULATED*
2121	177849.33	2353215.946	29.49	CED	12	REGULATED*
2122	177848.802	2353200.357	31.912	CED	12	REGULATED*
2159	177868.313	2353027.105	29.443	CED	12	REGULATED*
2162	177870.545	2353061.581	31.16	CED	12	REGULATED*
2163	177871.649	2353075	28.303	CED	12	REGULATED*
2586	176808.613	2353129.461	27.387	CED	14	REGULATED*
2158	177867.032	2353020.954	32.922	CED	16	REGULATED*
2119	177851.287	2353263.358	30.76	CED	22	REGULATED*
71	176875.588	2352690.692	26.999	GUM	8	REGULATED*
1126	176789.796	2352791.624	29.533	GUM	8	REGULATED*
1689	177292.709	2352832.447	29.365	GUM	8	REGULATED*
1720	177269.424	2353014.836	27.449	GUM	8	REGULATED*
1721	177275.765	2353020.218	26.941	GUM	8	REGULATED*
1722	177276.306	2353028.684	27.423	GUM	8	REGULATED*
1723	177268.504	2353026.534	27.38	GUM	8	REGULATED*
1847	177401.43	2353499.021	26.846	GUM	8	REGULATED*
1853	177393.614	2353475.083	27.074	GUM	8	REGULATED*
1854	177344.5	2353489.924	27.34	GUM	8	REGULATED*
1858	177337.39	2353483.824	26.729	GUM	8	REGULATED*
1859	177330.496	2353457.539	28.038	GUM	8	REGULATED*
1879	177487.105	2353554.156	28.132	GUM	8	REGULATED*
1880	177499.068	2353543.092	30.182	GUM	8	REGULATED*
1881	177503.663	2353549.711	34.472	GUM	8	REGULATED*
1882	177530.433	2353545.917	36.266	GUM	8	REGULATED*
1968	177871.065	2353873.032	32.705	GUM	8	REGULATED*
1969	177875.134	2353874.59	40.064	GUM	8	REGULATED*
1970	177873.26	2353867.956	35.478	GUM	8	REGULATED*
2040	177828.717	2353666.813	29.27	GUM	8	REGULATED*
2041	177822.372	2353662.622	30.172	GUM	8	REGULATED*
2042	177820.789	2353659.629	30.159	GUM	8	REGULATED*
2043	177823.837	2353657.774	30.241	GUM	8	REGULATED*
2074	177884.148	2353572.91	33.62	GUM	8	REGULATED*
2259	177070.793	2353277.675	23.31	GUM	8	REGULATED*
2399	176975.81	2352745.045	29.545	GUM	8	REGULATED*
2426	176912.407	2352791.112	29.885	GUM	8	REGULATED*
2427	176947.182	2352780.858	28.751	GUM	8	REGULATED*
2437	176896.1	2352878.43	32.495	GUM	8	REGULATED*
2452	176881.185	2352791.267	26.56	GUM	8	REGULATED*
2471	176896.909	2352879.359	26.628	GUM	8	REGULATED*
2472	176901.698	2352868.207	26.368	GUM	8	REGULATED*

2473	176907.759	2352875.046	27.021	GUM	8	REGULATED*
2482	176970.612	2352896.417	33.92	GUM	8	REGULATED*
2485	176916.677	2352914.158	31.585	GUM	8	REGULATED*
2497	176880.065	2352920.683	25.86	GUM	8	REGULATED*
2510	176826.39	2352930.9	22.304	GUM	8	REGULATED*
2511	176856.947	2352953.534	37.579	GUM	8	REGULATED*
2519	176789.18	2352956.19	20.327	GUM	8	REGULATED*
2523	176779.475	2352982.659	34.795	GUM	8	REGULATED*
2528	176772.446	2352937.196	25.115	GUM	8	REGULATED*
2529	176771.441	2352933.578	26.305	GUM	8	REGULATED*
2563	176732.96	2353089.58	42.306	GUM	8	REGULATED*
2640	177095.426	2353194.105	38.357	GUM	8	REGULATED*
2641	177093.507	2353183.777	33.013	GUM	8	REGULATED*
2642	177092.475	2353176.212	29.293	GUM	8	REGULATED*
2643	177091.713	2353211.942	39.985	GUM	8	REGULATED*
2644	177089.946	2353203.794	38.416	GUM	8	REGULATED*
2645	177087.639	2353193.327	38.094	GUM	8	REGULATED*
2646	177086.557	2353199.171	35.449	GUM	8	REGULATED*
2827	177677.387	2353492.003	56.304	GUM	8	REGULATED*
2896	177177.473	2353016.637	29.998	GUM	8	REGULATED*
2900	177146.148	2353037.897	35.254	GUM	8	REGULATED*
1755	177343.598	2353096.176	49.66	GUM	10	REGULATED*
1806	177320.965	2353197.762	30.045	GUM	10	REGULATED*
1825	177318.565	2353345.958	27.897	GUM	10	REGULATED*
1920	177561.349	2353668.8	50.181	GUM	10	REGULATED*
2033	177868.097	2353704.256	29.937	GUM	10	REGULATED*
2038	177864.796	2353667.59	45.849	GUM	10	REGULATED*
2045	177863.158	2353639.527	35.711	GUM	10	REGULATED*
2261	177072.71	2353290.05	20.89	GUM	10	REGULATED*
2262	177071.811	2353294.097	20.95	GUM	10	REGULATED*
2400	176966.57	2352761.409	47.897	GUM	10	REGULATED*
2431	176946.434	2352811.511	36.289	GUM	10	REGULATED*
2432	176927.832	2352842.112	24.999	GUM	10	REGULATED*
2440	176884.299	2352822.789	27.288	GUM	10	REGULATED*
2474	176917.965	2352867.837	25.216	GUM	10	REGULATED*
2478	176963.746	2352890.641	27.866	GUM	10	REGULATED*
2481	176957.747	2352898.897	24.164	GUM	10	REGULATED*
2483	176974.626	2352900.007	52.487	GUM	10	REGULATED*
2490	176916.068	2352951.909	24.301	GUM	10	REGULATED*
2513	176810.382	2352953.192	22.831	GUM	10	REGULATED*
2546	176704.412	2353029.759	34.241	GUM	10	REGULATED*
2553	176724.202	2353044.004	29.1	GUM	10	REGULATED*
2647	177084.998	2353205.998	29.69	GUM	10	REGULATED*
2648	177084.678	2353210.679	38.91	GUM	10	REGULATED*
2649	177080.133	2353211.619	44.154	GUM	10	REGULATED*
2695	177034.444	2352671.757	50.139	GUM	10	REGULATED*
2700	177132.157	2352611.134	55.334	GUM	10	REGULATED*

2895	177172.547	2353005.887	29.268	GUM	10	REGULATED*
2899	177150.695	2353035.664	29.357	GUM	10	REGULATED*
1759	177335.263	2353141.628	36.119	GUM	12	REGULATED*
1762	177321.394	2353196.806	34.11	GUM	12	REGULATED*
1802	177240.556	2353192.582	47.421	GUM	12	REGULATED*
1803	177276.297	2353244.142	24.727	GUM	12	REGULATED*
1924	177561.381	2353668.805	49.78	GUM	12	REGULATED*
1925	177589.539	2353669.218	57.24	GUM	12	REGULATED*
1937	177647.741	2353751.835	44.48	GUM	12	REGULATED*
1997	177863.386	2353675.115	46.263	GUM	12	REGULATED*
2026	177887.969	2353587.107	30.994	GUM	12	REGULATED*
2044	177861.411	2353645.898	33.036	GUM	12	REGULATED*
2046	177863.424	2353634.143	41.222	GUM	12	REGULATED*
2067	177859.431	2353474.334	46.94	GUM	12	REGULATED*
2089	177812.602	2353435.19	63.209	GUM	12	REGULATED*
2090	177798.62	2353440.737	58.775	GUM	12	REGULATED*
2118	177854.651	2353320.078	28.675	GUM	12	REGULATED*
2142	177850.998	2353128.479	36.161	GUM	12	REGULATED*
2143	177850.064	2353120.504	35.841	GUM	12	REGULATED*
2144	177846.575	2353122.475	41.133	GUM	12	REGULATED*
2265	177066.748	2353318.638	21.375	GUM	12	REGULATED*
2476	176947.465	2352864.144	26.211	GUM	12	REGULATED*
2486	176905.337	2352908.645	25.567	GUM	12	REGULATED*
2487	176931.913	2352930.228	25.374	GUM	12	REGULATED*
2491	176900.81	2352927.661	24.272	GUM	12	REGULATED*
2492	176897.82	2352969.722	28.259	GUM	12	REGULATED*
2494	176890.594	2352921.353	24.712	GUM	12	REGULATED*
2495	176893.379	2352911.747	24.484	GUM	12	REGULATED*
2496	176873.329	2352922.513	27.519	GUM	12	REGULATED*
2514	176862.026	2352999.687	31.739	GUM	12	REGULATED*
2559	176784.652	2353118.603	37.926	GUM	12	REGULATED*
2562	176752.338	2353123.212	33.063	GUM	12	REGULATED*
2572	176654.259	2352995.901	27.677	GUM	12	REGULATED*
2633	177138.968	2353053.653	51.784	GUM	12	REGULATED*
2634	177128.524	2353087.251	35.43	GUM	12	REGULATED*
2638	177098.302	2353180.704	30.386	GUM	12	REGULATED*
2639	177098.075	2353184.523	36.651	GUM	12	REGULATED*
2650	177078.638	2353223.75	51.78	GUM	12	REGULATED*
2767	177276.658	2352794.01	41.162	GUM	12	REGULATED*
2783	177657.97	2353748.088	60.274	GUM	12	REGULATED*
2824	177631.403	2353511.005	70.72	GUM	12	REGULATED*
2825	177642.558	2353493.42	67.684	GUM	12	REGULATED*
2826	177671.54	2353490.277	65.448	GUM	12	REGULATED*
2835	177756.951	2353453.426	52.386	GUM	12	REGULATED*
2836	177758.847	2353461.66	44.758	GUM	12	REGULATED*
2887	177092.564	2352921.446	48.712	GUM	12	REGULATED*
2901	177140.206	2353053.89	43.347	GUM	12	REGULATED*

1760	177328.624	2353165.965	41.657	GUM	14	REGULATED*
1919	177545.84	2353649.256	54.554	GUM	14	REGULATED*
2093	177856.768	2353371.277	32.271	GUM	14	REGULATED*
2257	177071.201	2353255.318	32.967	GUM	14	REGULATED*
2297	177333.614	2353491.616	44.986	GUM	14	REGULATED*
2429	176919.297	2352804.844	27.183	GUM	14	REGULATED*
2430	176920.017	2352808.778	34.493	GUM	14	REGULATED*
2489	176927.37	2352940.726	24.033	GUM	14	REGULATED*
2493	176882.495	2352953.514	25.16	GUM	14	REGULATED*
2560	176745.004	2353100.117	32.234	GUM	14	REGULATED*
2635	177120.555	2353122.776	33.991	GUM	14	REGULATED*
2264	177071.767	2353309.307	21.244	GUM	16	REGULATED*
2515	176845.438	2352988.431	26.037	GUM	16	REGULATED*
2636	177117.881	2353134.027	32.568	GUM	16	REGULATED*
1775	177134.993	2353079.327	35.218	GUM	18	REGULATED*
2484	176973.457	2352901.138	25.595	GUM	18	REGULATED*
1921	177600.129	2353723.075	41.71	GUM	20	REGULATED*
2521	176791.723	2352990.206	23.09	GUM	20	REGULATED*
2704	177121.114	2352718.384	30.056	GUM	20	REGULATED*
2888	177112.675	2352924.723	53.662	GUM	20	REGULATED*
2123	177847.233	2353187.639	36.963	HIC	12	REGULATED*
2124	177846.686	2353161.613	36.656	HIC	12	REGULATED*
2662	177019.41	2353042.463	45.432	HIC	16	REGULATED*
2730	177225.476	2352792.531	27.221	HOL	8	REGULATED*
2758	177206.677	2352838.39	25.385	HOL	8	REGULATED*
81	176902.322	2353048.598	26.599	HOL	10	REGULATED*
2759	177164.349	2352890.882	25.463	HOL	12	REGULATED*
72	176890.886	2352697.714	29.131	MAG	4	REGULATED*
2516	176806.241	2352958.515	21.461	MAG	6	REGULATED*
1124	176780.456	2352808.98	26.483	MAG	8	SIGNIFICANT
2007	177890.742	2353774.241	31.33	MAG	10	SIGNIFICANT
2160	177868.527	2353038.277	29.606	MAG	12	SIGNIFICANT
2498	176881.155	2352905.025	25.197	MAG	14	SIGNIFICANT
2064	177860.12	2353534.02	34.505	MAG	18	SIGNIFICANT
2164	177843.48	2353050.769	30.459	MAG	42	SIGNIFICANT
1684	177285.854	2352763.694	31.446	MAP	8	REGULATED*
2087	177858.4	2353474.034	46.795	MAP	8	REGULATED*
2207	177065.433	2352614.116	40.037	MAP	8	REGULATED*
2208	177085.891	2352608.433	28.359	MAP	8	REGULATED*
2435	176901.365	2352867.459	27.419	MAP	8	REGULATED*
2506	176896.439	2352852.235	55.364	MAP	8	REGULATED*
2538	176804.879	2352927.048	26.511	MAP	8	REGULATED*
2550	176730.65	2353028.54	25.856	MAP	8	REGULATED*
2551	176758.419	2353020.27	38.659	MAP	8	REGULATED*
2557	176735.772	2353056.834	30.099	MAP	8	REGULATED*
2060	177865.562	2353583.677	34.773	MAP	10	REGULATED*
2061	177863.777	2353580.023	34.534	MAP	10	REGULATED*

2436	176899.079	2352851.976	30.189	MAP	10	REGULATED*
2548	176734.184	2353015.432	31.624	MAP	10	REGULATED*
83	176875.888	2353000.824	38.152	MAP	12	REGULATED*
1973	177899.337	2353857.491	49.026	MAP	12	REGULATED*
2059	177864.714	2353595.544	35.063	MAP	12	REGULATED*
2537	176801.328	2352927.43	27.393	MAP	12	REGULATED*
2556	176772.972	2353042.459	35.53	MAP	12	REGULATED*
2588	176761.389	2353122.782	58.525	MAP	12	REGULATED*
2589	176801.068	2353069.375	41.494	MAP	12	REGULATED*
2592	176861.468	2353004.931	63.676	MAP	12	REGULATED*
2047	177865.301	2353584.522	32.918	MAP	14	REGULATED*
2554	176721.572	2353046.487	24.829	MAP	14	REGULATED*
2561	176754.453	2353121.979	37.412	MAP	14	REGULATED*
2590	176807.791	2353065.36	84.646	MAP	14	REGULATED*
2591	176822.038	2353035.242	52.159	MAP	14	REGULATED*
2731	177113.359	2352886.594	24.623	MAP	14	REGULATED*
2760	177167.837	2352863.651	24.988	MAP	14	REGULATED*
2351	176753.962	2353126.723	57.338	MAP	20	REGULATED*
2522	176782.38	2352991.412	37.822	MAP	20	REGULATED*
1125	176778.245	2352805.35	28.774	OAK	8	REGULATED*
1954	177712.782	2353868.893	26.902	OAK	8	REGULATED*
2062	177860.245	2353541.841	29.679	OAK	8	REGULATED*
2069	177884.715	2353482.36	33.137	OAK	8	REGULATED*
2201	177018.547	2352586.161	28.067	OAK	8	REGULATED*
2409	176931.311	2352701.48	40.729	OAK	8	REGULATED*
2428	176918.485	2352791.481	27.158	OAK	8	REGULATED*
2434	176903.662	2352805.694	25.502	OAK	8	REGULATED*
2456	176868.273	2352770.509	26.891	OAK	8	REGULATED*
2691	177009.423	2352754.48	27.54	OAK	8	REGULATED*
2689	177004.119	2352819.316	28.763	OAK	10	REGULATED*
1955	177721.188	2353866.611	32.409	OAK	12	REGULATED*
2210	177049.076	2352630.763	25.251	OAK	12	REGULATED*
2512	176874.416	2353001.578	45.816	OAK	12	REGULATED*
2690	177032.687	2352748.155	26.73	OAK	12	REGULATED*
2757	177169.98	2352910.476	25.499	OAK	12	REGULATED*
2065	177858.275	2353522.954	42.346	OAK	14	REGULATED*
2694	177041.736	2352688.928	39.6	OAK	14	REGULATED*
2753	177238.975	2352833.728	28.801	OAK	14	REGULATED*
2756	177228.132	2352817.449	26.124	OAK	14	REGULATED*
2754	177203.23	2352887.441	31.025	OAK	16	REGULATED*
2630	177045.912	2353089.417	35.999	OAK	20	REGULATED*
2751	177255.201	2352814.884	25.357	OAK	20	REGULATED*
2141	177846.851	2353131.742	29.893	OAK	24	SIGNIFICANT
2660	177037.993	2352914.409	54.847	OAK	24	SIGNIFICANT
2687	177052.903	2352769.655	29.477	OAK	24	SIGNIFICANT
87	176967.922	2353039.815	27.561	OAK	28	SIGNIFICANT

2610	177014.009	2353137.48	30.289	OAK	60	SIGNIFICANT**
85	176955.952	2353014.562	35.539	PINE	12	REGULATED*
86	176991.922	2353012.969	36.634	PINE	12	REGULATED*
1076	176984.279	2352548.395	28.353	PINE	12	REGULATED*
1077	176944.543	2352566.58	31.214	PINE	12	REGULATED*
1079	176916.17	2352608.551	29.282	PINE	12	REGULATED*
1127	176783.006	2352842.686	33.411	PINE	12	REGULATED*
1128	176776.459	2352885.199	32.816	PINE	12	REGULATED*
1131	176720.57	2352892.223	26.868	PINE	12	REGULATED*
1585	177146.262	2352613.359	61.551	PINE	12	REGULATED*
1605	177144.436	2352614.964	34.804	PINE	12	REGULATED*
1606	177142.394	2352620.592	52.118	PINE	12	REGULATED*
1607	177148.529	2352635.579	62.606	PINE	12	REGULATED*
1608	177168.151	2352647.569	51.037	PINE	12	REGULATED*
1618	177149.09	2352635.183	46.42	PINE	12	REGULATED*
1650	177203.142	2352675.95	61.879	PINE	12	REGULATED*
1651	177283.691	2352724.431	45.863	PINE	12	REGULATED*
1665	177290.498	2352761.499	42.015	PINE	12	REGULATED*
1666	177285.82	2352770.331	45.322	PINE	12	REGULATED*
1685	177301.702	2352784.559	33.279	PINE	12	REGULATED*
1686	177310.71	2352793.288	31.905	PINE	12	REGULATED*
1724	177253.274	2353040.135	28.306	PINE	12	REGULATED*
1725	177234.772	2353083.423	29.81	PINE	12	REGULATED*
1726	177245.311	2353048.896	27.088	PINE	12	REGULATED*
1727	177237.722	2353070.49	26.912	PINE	12	REGULATED*
1729	177232.764	2353063.53	23.402	PINE	12	REGULATED*
1730	177182.439	2352999.38	38.596	PINE	12	REGULATED*
1753	177329.557	2353071.494	69.037	PINE	12	REGULATED*
1756	177329.395	2353123.085	53.119	PINE	12	REGULATED*
1757	177340.135	2353132.786	52.239	PINE	12	REGULATED*
1763	177279.22	2353123.82	28.96	PINE	12	REGULATED*
1764	177272.973	2353188.093	54.128	PINE	12	REGULATED*
1765	177274.89	2353168.255	48.589	PINE	12	REGULATED*
1766	177267.679	2353175.516	46.28	PINE	12	REGULATED*
1768	177256.558	2353148.691	44.905	PINE	12	REGULATED*
1769	177255.317	2353138.354	34.753	PINE	12	REGULATED*
1772	177251.524	2353110.565	25.059	PINE	12	REGULATED*
1773	177264.377	2353091.644	26.843	PINE	12	REGULATED*
1774	177243.275	2353091.725	26.744	PINE	12	REGULATED*
1777	177271.798	2353069.277	29.697	PINE	12	REGULATED*
1793	177327.48	2353278.753	27.995	PINE	12	REGULATED*
1796	177281.746	2353316.027	25.578	PINE	12	REGULATED*
1797	177263.926	2353332.683	45.844	PINE	12	REGULATED*
1799	177296.21	2353243.786	29.147	PINE	12	REGULATED*
1800	177285.881	2353230.389	37.941	PINE	12	REGULATED*
1804	177304.47	2353226.699	26.822	PINE	12	REGULATED*
1805	177300.304	2353194.97	27.377	PINE	12	REGULATED*

1814	177380.37	2353435.077	29.189	PINE	12	REGULATED*
1815	177363.115	2353374.232	27.067	PINE	12	REGULATED*
1818	177287.029	2353426.414	33.77	PINE	12	REGULATED*
1819	177314.826	2353391.976	28.521	PINE	12	REGULATED*
1824	177278.699	2353367.865	58.305	PINE	12	REGULATED*
1826	177333.074	2353302.507	25.536	PINE	12	REGULATED*
1827	177280.512	2353315.453	55.921	PINE	12	REGULATED*
1846	177437.714	2353504.937	29.833	PINE	12	REGULATED*
1861	177387.118	2353468.669	26.965	PINE	12	REGULATED*
1862	177387.459	2353459.422	28.31	PINE	12	REGULATED*
1863	177381.314	2353436.055	29.818	PINE	12	REGULATED*
1877	177455.109	2353571.278	26.778	PINE	12	REGULATED*
1935	177577.625	2353709.322	38.143	PINE	12	REGULATED*
1936	177579.085	2353722.489	32.412	PINE	12	REGULATED*
1950	177652.381	2353855.059	31.672	PINE	12	REGULATED*
1952	177682.149	2353842.535	43.634	PINE	12	REGULATED*
1956	177775.361	2353864.503	49.75	PINE	12	REGULATED*
1957	177780.984	2353871.545	41.443	PINE	12	REGULATED*
1965	177813.192	2353859.472	41.278	PINE	12	REGULATED*
1966	177825.221	2353851.535	52.97	PINE	12	REGULATED*
1967	177843.216	2353850.363	62.828	PINE	12	REGULATED*
1971	177868.546	2353826.381	69.288	PINE	12	REGULATED*
1972	177864.508	2353796.122	78.616	PINE	12	REGULATED*
1989	177866.029	2353779.145	33.086	PINE	12	REGULATED*
1991	177831.062	2353784.97	37.453	PINE	12	REGULATED*
1993	177863.479	2353740.466	33.355	PINE	12	REGULATED*
1994	177824.137	2353694.324	78.735	PINE	12	REGULATED*
2000	177891.456	2353667.629	36.391	PINE	12	REGULATED*
2002	177893.269	2353724.432	31.171	PINE	12	REGULATED*
2003	177892.496	2353747.403	31.915	PINE	12	REGULATED*
2030	177889.846	2353645.112	33.171	PINE	12	REGULATED*
2034	177867.981	2353700.479	30.035	PINE	12	REGULATED*
2035	177867.006	2353697.768	32.866	PINE	12	REGULATED*
2036	177864.869	2353686.05	40.775	PINE	12	REGULATED*
2066	177857.423	2353490.985	40.86	PINE	12	REGULATED*
2068	177886.29	2353460.151	35.144	PINE	12	REGULATED*
2088	177839.187	2353456.533	56.712	PINE	12	REGULATED*
2092	177832.102	2353383.078	29.194	PINE	12	REGULATED*
2109	177870.223	2353205.564	28.633	PINE	12	REGULATED*
2120	177849.682	2353248.213	30.083	PINE	12	REGULATED*
2185	177015.055	2352632.006	34.661	PINE	12	REGULATED*
2186	176988.515	2352640.834	36.98	PINE	12	REGULATED*
2190	176962.89	2352649.767	39.358	PINE	12	REGULATED*
2192	176963.656	2352618.811	29.873	PINE	12	REGULATED*
2193	176998.732	2352607.765	26.216	PINE	12	REGULATED*
2198	177010.619	2352598.12	28.855	PINE	12	REGULATED*
2199	177018.076	2352548.708	34.344	PINE	12	REGULATED*

2200	177010.717	2352598.155	27.299	PINE	12	REGULATED*
2202	177024.389	2352598.267	30.512	PINE	12	REGULATED*
2203	177048.989	2352569.429	47.214	PINE	12	REGULATED*
2204	177039.703	2352576.061	45.164	PINE	12	REGULATED*
2211	177037.276	2352628.967	26.624	PINE	12	REGULATED*
2280	177161.743	2353388.194	44.137	PINE	12	REGULATED*
2293	177286.38	2353428.061	30.474	PINE	12	REGULATED*
2313	177264.133	2353333.767	41.344	PINE	12	REGULATED*
2352	176784.454	2353118.233	52.349	PINE	12	REGULATED*
2401	176962.958	2352720.847	35.579	PINE	12	REGULATED*
2404	176936.236	2352747.519	44.262	PINE	12	REGULATED*
2433	176917.847	2352833.56	25.086	PINE	12	REGULATED*
2441	176832.452	2352886.819	31.986	PINE	12	REGULATED*
2445	176805.223	2352849.538	41.467	PINE	12	REGULATED*
2446	176815.933	2352840.129	39.455	PINE	12	REGULATED*
2448	176874.737	2352806.834	27.817	PINE	12	REGULATED*
2449	176861.524	2352809.394	28.87	PINE	12	REGULATED*
2455	176845.756	2352764.278	29.272	PINE	12	REGULATED*
2475	176939.101	2352865.536	21.153	PINE	12	REGULATED*
2480	176943.689	2352896.831	32.555	PINE	12	REGULATED*
2501	176837.578	2352863.141	32.199	PINE	12	REGULATED*
2502	176843.958	2352842.219	72.291	PINE	12	REGULATED*
2503	176830.027	2352810.596	36.323	PINE	12	REGULATED*
2504	176882.659	2352842.49	33.55	PINE	12	REGULATED*
2517	176844.331	2352954.38	28.457	PINE	12	REGULATED*
2535	176795.089	2352880.367	40.117	PINE	12	REGULATED*
2536	176827.737	2352887.359	51.148	PINE	12	REGULATED*
2570	176669.06	2353029.828	53.848	PINE	12	REGULATED*
2587	176785.653	2353118.559	54.976	PINE	12	REGULATED*
2593	176955.446	2353201.904	53.262	PINE	12	REGULATED*
2614	177014.698	2353165.544	28.38	PINE	12	REGULATED*
2615	177001.101	2353176.516	30.415	PINE	12	REGULATED*
2616	176997.649	2353183.901	31.818	PINE	12	REGULATED*
2617	176977.705	2353191.776	27.226	PINE	12	REGULATED*
2618	176973.187	2353194.595	26.432	PINE	12	REGULATED*
2619	176956.543	2353201.647	35.082	PINE	12	REGULATED*
2620	176953.682	2353202.295	34.07	PINE	12	REGULATED*
2628	177044.594	2353133.042	31.979	PINE	12	REGULATED*
2629	177063.514	2353137.812	30.558	PINE	12	REGULATED*
2632	177079.678	2353094.398	30.624	PINE	12	REGULATED*
2652	177036.838	2353154.809	37.63	PINE	12	REGULATED*
2658	177000.302	2352988.055	27.938	PINE	12	REGULATED*
2659	177014.78	2352954.029	27.532	PINE	12	REGULATED*
2663	177051.571	2353028.692	39.861	PINE	12	REGULATED*
2692	177002.057	2352719.143	49.618	PINE	12	REGULATED*
2693	177021.51	2352694.212	54.896	PINE	12	REGULATED*

2696	177054.266	2352647.51	58.737	PINE	12	REGULATED*
2697	177063.566	2352635.129	67.975	PINE	12	REGULATED*
2698	177078.241	2352623.869	76.57	PINE	12	REGULATED*
2701	177148.292	2352636.786	78.126	PINE	12	REGULATED*
2702	177167.325	2352648.645	62.643	PINE	12	REGULATED*
2703	177201.619	2352676.992	77.072	PINE	12	REGULATED*
2748	177283.136	2352834.771	47.948	PINE	12	REGULATED*
2761	177242.601	2352720.992	65.195	PINE	12	REGULATED*
2762	177251.326	2352741.425	62.26	PINE	12	REGULATED*
2763	177269.716	2352748.954	57.82	PINE	12	REGULATED*
2764	177276.429	2352759.477	55.365	PINE	12	REGULATED*
2766	177301.147	2352784.453	62.539	PINE	12	REGULATED*
2777	177802.569	2353791.209	35.393	PINE	12	REGULATED*
2779	177715.917	2353812.74	46.279	PINE	12	REGULATED*
2780	177716.483	2353785.951	32.275	PINE	12	REGULATED*
2781	177695.992	2353771.076	45.952	PINE	12	REGULATED*
2782	177703.787	2353757.915	33.897	PINE	12	REGULATED*
2784	177662.591	2353718.575	56.083	PINE	12	REGULATED*
2785	177723.866	2353745.53	32.474	PINE	12	REGULATED*
2786	177723.481	2353732.504	35.049	PINE	12	REGULATED*
2787	177741.424	2353731.774	33.838	PINE	12	REGULATED*
2788	177734.893	2353745.71	30.257	PINE	12	REGULATED*
2789	177754.723	2353741.23	34.557	PINE	12	REGULATED*
2795	177720.317	2353680.492	41.624	PINE	12	REGULATED*
2797	177700.561	2353647.854	30.473	PINE	12	REGULATED*
2798	177661.031	2353653.952	34.911	PINE	12	REGULATED*
2799	177660.29	2353612.749	29.156	PINE	12	REGULATED*
2800	177678.462	2353624.239	30.493	PINE	12	REGULATED*
2802	177696.777	2353616.051	30.327	PINE	12	REGULATED*
2803	177696.229	2353609.701	30.569	PINE	12	REGULATED*
2804	177704.522	2353622.133	30.104	PINE	12	REGULATED*
2805	177711.8	2353593.263	33.425	PINE	12	REGULATED*
2806	177710.658	2353624.385	30.96	PINE	12	REGULATED*
2807	177709.65	2353639.973	29.809	PINE	12	REGULATED*
2808	177722.079	2353629.89	32.154	PINE	12	REGULATED*
2809	177753.054	2353635.065	39.996	PINE	12	REGULATED*
2810	177753.056	2353642.561	37.424	PINE	12	REGULATED*
2817	177756.932	2353541.467	28.888	PINE	12	REGULATED*
2818	177756.575	2353555.01	37.421	PINE	12	REGULATED*
2819	177750.364	2353569.57	44.092	PINE	12	REGULATED*
2820	177729.052	2353561.146	33.913	PINE	12	REGULATED*
2821	177708.844	2353557.181	36.294	PINE	12	REGULATED*
2822	177648.094	2353575.144	32.789	PINE	12	REGULATED*
2823	177655.275	2353565.091	35.863	PINE	12	REGULATED*
2828	177693.96	2353515.439	50.344	PINE	12	REGULATED*
2829	177712.358	2353508.382	36	PINE	12	REGULATED*
2830	177719.254	2353514.97	32.303	PINE	12	REGULATED*

2831	177722.715	2353501.322	32.472	PINE	12	REGULATED*
2832	177722.824	2353494.43	31.827	PINE	12	REGULATED*
2833	177727.324	2353526.701	30.298	PINE	12	REGULATED*
2834	177734.471	2353505.869	30.513	PINE	12	REGULATED*
2837	177735.235	2353533.403	30.975	PINE	12	REGULATED*
2838	177757.995	2353529.698	28.238	PINE	12	REGULATED*
2884	177133.513	2353021.067	35.091	PINE	12	REGULATED*
2885	177145.36	2352996.199	28.769	PINE	12	REGULATED*
2886	177123.613	2352975.109	29.643	PINE	12	REGULATED*
2889	177165.538	2352931.301	73.594	PINE	12	REGULATED*
2891	177156.261	2352980.842	31.137	PINE	12	REGULATED*
2902	177134.853	2353095.466	35.738	PINE	12	REGULATED*
1701	177244.284	2352912.494	45.573	PINE	12	REGULATED*
1119	176854.746	2352705.171	28.947	PINE	14	REGULATED*
1129	176757.452	2352851.19	31.236	PINE	14	REGULATED*
1130	176741.977	2352865.837	27.154	PINE	14	REGULATED*
1582	177078.773	2352623.166	45.103	PINE	14	REGULATED*
1699	177269.922	2352874.458	51.676	PINE	14	REGULATED*
1732	177203.632	2352989.866	33.717	PINE	14	REGULATED*
1733	177200.821	2352976.445	29.286	PINE	14	REGULATED*
1758	177325.649	2353132.487	41.462	PINE	14	REGULATED*
1767	177265.389	2353145.736	27.666	PINE	14	REGULATED*
1770	177251.705	2353129.587	31.14	PINE	14	REGULATED*
1820	177276.188	2353427.202	73.945	PINE	14	REGULATED*
1821	177262.155	2353419.753	56.415	PINE	14	REGULATED*
1822	177311.303	2353369.851	27.41	PINE	14	REGULATED*
1918	177533.733	2353671.049	31.739	PINE	14	REGULATED*
1951	177662.686	2353846.789	34.326	PINE	14	REGULATED*
1996	177867.07	2353702.267	48.375	PINE	14	REGULATED*
1999	177863.965	2353656.154	50.948	PINE	14	REGULATED*
2001	177890.693	2353723.597	34.984	PINE	14	REGULATED*
2023	177881.221	2353518.475	30.729	PINE	14	REGULATED*
2063	177827.649	2353529.593	29.679	PINE	14	REGULATED*
2070	177881.261	2353518.374	31.748	PINE	14	REGULATED*
2091	177855.049	2353402.843	32.243	PINE	14	REGULATED*
2099	177884.765	2353443.061	35.008	PINE	14	REGULATED*
2110	177870.822	2353226.946	27.832	PINE	14	REGULATED*
2112	177874.473	2353248.951	26.009	PINE	14	REGULATED*
2138	177872.347	2353166.494	29.656	PINE	14	REGULATED*
2139	177872.589	2353175.975	31.836	PINE	14	REGULATED*
2194	176981.919	2352591.372	24.063	PINE	14	REGULATED*
2195	176997.375	2352590.829	25.412	PINE	14	REGULATED*
2196	176992.977	2352578.951	29.692	PINE	14	REGULATED*
2197	176998.144	2352581.81	25.579	PINE	14	REGULATED*
2205	177075.482	2352575.286	31.748	PINE	14	REGULATED*
2206	177045.916	2352603.65	24.052	PINE	14	REGULATED*
2209	177020.785	2352615.68	26.447	PINE	14	REGULATED*

2212	177076.835	2352624.949	33.018	PINE	14	REGULATED*
2295	177308.127	2353442.411	39.089	PINE	14	REGULATED*
2347	176731.811	2353116.853	26.376	PINE	14	REGULATED*
2403	176961.128	2352716.523	34.314	PINE	14	REGULATED*
2405	176945.943	2352723.809	36.744	PINE	14	REGULATED*
2407	176896.746	2352745.063	51.299	PINE	14	REGULATED*
2410	176933.672	2352687.768	33.803	PINE	14	REGULATED*
2423	176912.355	2352783.009	26.5	PINE	14	REGULATED*
2424	176921.923	2352772.677	30.126	PINE	14	REGULATED*
2439	176882.632	2352841.254	32.668	PINE	14	REGULATED*
2447	176864.438	2352812.301	31.382	PINE	14	REGULATED*
2450	176829.346	2352809.3	31.905	PINE	14	REGULATED*
2454	176836.471	2352775.888	25.395	PINE	14	REGULATED*
2457	176885.154	2352748.502	50.807	PINE	14	REGULATED*
2458	176898.714	2352786.279	29.021	PINE	14	REGULATED*
2459	176897.031	2352772.615	32.25	PINE	14	REGULATED*
2461	176904.865	2352720.617	36.827	PINE	14	REGULATED*
2477	176943.16	2352887.108	23.054	PINE	14	REGULATED*
2499	176833.686	2352888.028	46.097	PINE	14	REGULATED*
2500	176839.378	2352875.826	29.388	PINE	14	REGULATED*
2530	176753.94	2352911.444	33.214	PINE	14	REGULATED*
2532	176759.598	2352882.908	39.456	PINE	14	REGULATED*
2533	176782.578	2352925.095	28.649	PINE	14	REGULATED*
2547	176726.392	2352991.054	35.285	PINE	14	REGULATED*
2564	176731.474	2353115.121	37.178	PINE	14	REGULATED*
2565	176695.98	2353089.559	49.241	PINE	14	REGULATED*
2571	176668.27	2353013.35	54.973	PINE	14	REGULATED*
2613	177021.423	2353159.973	28.442	PINE	14	REGULATED*
2661	177029.58	2352986.053	27.916	PINE	14	REGULATED*
2750	177269.351	2352865.855	26.855	PINE	14	REGULATED*
2765	177284.705	2352771.279	57.752	PINE	14	REGULATED*
2793	177720.268	2353653.812	30.861	PINE	14	REGULATED*
2794	177720.533	2353660.929	30.857	PINE	14	REGULATED*
2796	177701.386	2353651.951	31.382	PINE	14	REGULATED*
2801	177696.717	2353623.577	30.095	PINE	14	REGULATED*
2844	177682.502	2353010.31	32.579	PINE	14	REGULATED*
2893	177188.839	2352989.763	36.437	PINE	14	REGULATED*
1078	176943.604	2352583.633	32.25	PINE	16	REGULATED*
1123	176828.349	2352809.787	30.608	PINE	16	REGULATED*
1731	177182.439	2352999.382	38.596	PINE	16	REGULATED*
1754	177346.68	2353084.912	44.844	PINE	16	REGULATED*
1801	177235.279	2353200.641	60.233	PINE	16	REGULATED*
1816	177322.887	2353439.243	49.333	PINE	16	REGULATED*
1823	177282.463	2353382.569	28.578	PINE	16	REGULATED*
1855	177335.568	2353491.977	26.688	PINE	16	REGULATED*
1856	177353.622	2353479.765	26.883	PINE	16	REGULATED*
1911	177539.57	2353732.158	30.844	PINE	16	REGULATED*

1917	177523.263	2353663.87	36.99	PINE	16	REGULATED*
1938	177620.88	2353760.663	39.408	PINE	16	REGULATED*
2028	177889.012	2353613.494	29.982	PINE	16	REGULATED*
2032	177890.623	2353666.511	32.375	PINE	16	REGULATED*
2072	177884.325	2353552.31	36.021	PINE	16	REGULATED*
2116	177877.244	2353296.841	38.284	PINE	16	REGULATED*
2125	177848.083	2353151.898	38.297	PINE	16	REGULATED*
2187	176979.133	2352650.65	29.195	PINE	16	REGULATED*
2188	176986.535	2352634.008	31.652	PINE	16	REGULATED*
2189	176970.428	2352650.531	38.281	PINE	16	REGULATED*
2191	176966.047	2352629.856	27.914	PINE	16	REGULATED*
2254	177024.87	2353272.283	20.317	PINE	16	REGULATED*
2296	177266.464	2353435.66	30.313	PINE	16	REGULATED*
2402	176960.86	2352733.06	39.319	PINE	16	REGULATED*
2408	176905.647	2352719.703	25.275	PINE	16	REGULATED*
2438	176885.047	2352840.221	24.104	PINE	16	REGULATED*
2442	176838.853	2352874.853	34.497	PINE	16	REGULATED*
2443	176795.526	2352880.072	37.145	PINE	16	REGULATED*
2444	176845.351	2352840.996	33.178	PINE	16	REGULATED*
2453	176846.871	2352778.804	25.419	PINE	16	REGULATED*
2518	176802.298	2352973.176	28.092	PINE	16	REGULATED*
2524	176780.802	2352955.803	27.212	PINE	16	REGULATED*
2525	176744.828	2352978.132	50.086	PINE	16	REGULATED*
2531	176749.42	2352901.557	47.282	PINE	16	REGULATED*
2549	176744.359	2352979.735	32.134	PINE	16	REGULATED*
2552	176748.954	2353022.446	36.533	PINE	16	REGULATED*
2555	176796.69	2353014.224	27.38	PINE	16	REGULATED*
2568	176688.576	2353064.538	30.925	PINE	16	REGULATED*
2569	176646.374	2353037.923	68.416	PINE	16	REGULATED*
2611	177043.877	2353132.45	33.731	PINE	16	REGULATED*
2755	177192.476	2352906.595	31.824	PINE	16	REGULATED*
2892	177189.88	2352939.87	48.423	PINE	16	REGULATED*
1080	176910.481	2352631.975	29.328	PINE	18	REGULATED*
1120	176834.636	2352727.057	28.788	PINE	18	REGULATED*
1121	176816.785	2352767.222	25.442	PINE	18	REGULATED*
1122	176818.988	2352790.317	25.398	PINE	18	REGULATED*
1794	177280.509	2353381.254	38.611	PINE	18	REGULATED*
1860	177382.388	2353460.267	33.826	PINE	18	REGULATED*
1878	177473.614	2353559.29	28.741	PINE	18	REGULATED*
1883	177510.246	2353575.787	55.636	PINE	18	REGULATED*
1988	177870.4	2353783.519	39.378	PINE	18	REGULATED*
1992	177806.848	2353792.802	40.42	PINE	18	REGULATED*
2292	177290.498	2353407.211	36.449	PINE	18	REGULATED*
2294	177275.093	2353427.773	28.827	PINE	18	REGULATED*
2314	177292.523	2353330.676	44.22	PINE	18	REGULATED*
2406	176952.219	2352706.388	31.769	PINE	18	REGULATED*
2425	176913.261	2352787.724	30.325	PINE	18	REGULATED*

2451	176868.688	2352798.938	37.045	PINE	18	REGULATED*
2460	176896.562	2352746.369	49.375	PINE	18	REGULATED*
2462	176921.451	2352753.393	25.857	PINE	18	REGULATED*
2479	176925.361	2352898.331	25.843	PINE	18	REGULATED*
2488	176916.813	2352921.039	21.248	PINE	18	REGULATED*
2505	176885.579	2352841.343	36.9	PINE	18	REGULATED*
2520	176797.088	2353013.377	24.255	PINE	18	REGULATED*
2526	176719.418	2352964.559	36.389	PINE	18	REGULATED*
2534	176776.93	2352887.589	34.845	PINE	18	REGULATED*
2558	176810.42	2353086.909	36.226	PINE	18	REGULATED*
2612	177035.379	2353154.812	31.206	PINE	18	REGULATED*
2651	177070.056	2353241.164	44.378	PINE	18	REGULATED*
2890	177182.991	2352937.961	53.04	PINE	18	REGULATED*
2897	177168.479	2353022.589	30.831	PINE	18	REGULATED*
84	176892.086	2353004.218	35.472	PINE	20	REGULATED*
1742	177182.584	2352998.795	34.108	PINE	20	REGULATED*
1817	177321.3	2353396.908	41.097	PINE	20	REGULATED*
1857	177353.546	2353477.815	26.887	PINE	20	REGULATED*
1953	177691.921	2353849.274	33.591	PINE	20	REGULATED*
1990	177868.743	2353760.757	32.176	PINE	20	REGULATED*
1995	177865.481	2353722.316	45.669	PINE	20	REGULATED*
2140	177876.792	2353191.525	34.559	PINE	20	REGULATED*
2255	177069.348	2353241.806	52.221	PINE	20	REGULATED*
2263	177075.367	2353297.605	21.104	PINE	20	REGULATED*
2291	177280.618	2353382.304	69.439	PINE	20	REGULATED*
2298	177261.526	2353441.726	30.783	PINE	20	REGULATED*
2637	177106.171	2353148.52	28.367	PINE	20	REGULATED*
2778	177771.782	2353799.87	33.551	PINE	20	REGULATED*
2894	177180.849	2352999.049	36.698	PINE	20	REGULATED*
2898	177161.437	2353019.15	30.16	PINE	20	REGULATED*
1761	177323.971	2353173.782	37.495	PINE	24	REGULATED*
1795	177295.515	2353329.571	30.61	PINE	24	REGULATED*
1798	177301.716	2353271.515	27.115	PINE	24	REGULATED*
2256	177065.608	2353260.818	38.104	PINE	24	REGULATED*
2267	177068.806	2353330.366	30.839	PINE	26	REGULATED*
82	176891.511	2353049.327	26.177	PINE	30	REGULATED*
1845	177413.835	2353464.657	28.118	PINE	34	SIGNIFICANT
2527	176756.765	2352945.958	26.044	PINE	36	SIGNIFICANT

**60" Oak not included in mitigation calculations due to status as diseased/dying, per City Arborist

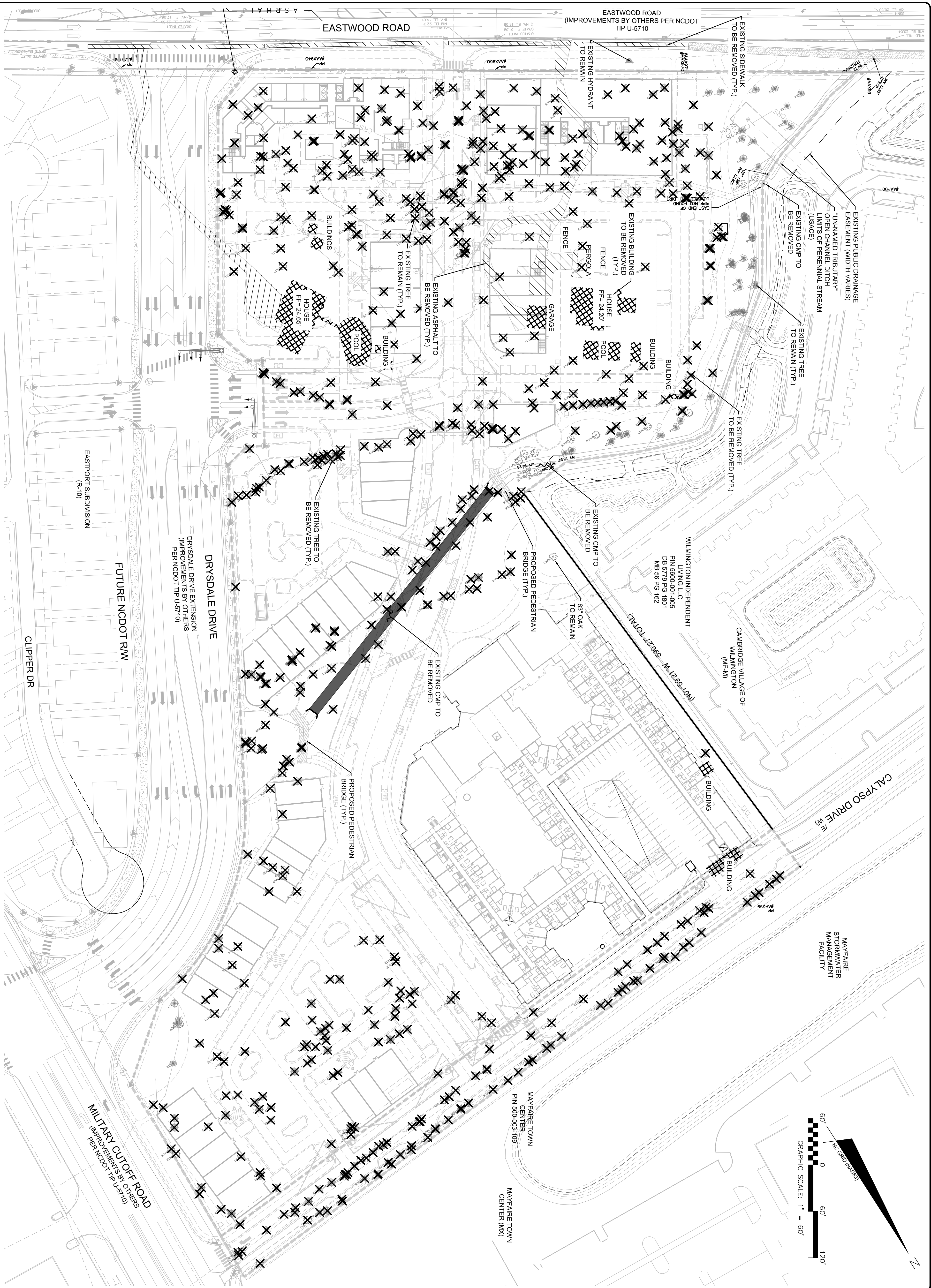

2 TREE INVENTORY

1	NEW HANOVER COUNTY ZONING AND EROSION CONTROL RE-EXAMINATION	02/01/2022
2	NEW HANOVER COUNTY ZONING AND EROSION CONTROL RE-EXAMINATION	02/01/2022
3	CADRE TEAM PUBLIC UTILITY AUTHORITY RE-EXAMINATION	12/17/2021
4	NEW HANOVER COUNTY ZONING AND EROSION CONTROL RE-EXAMINATION	12/15/2021
5	NEW HANOVER COUNTY ZONING AND EROSION CONTROL RE-EXAMINATION	12/03/2021
6	CITY OF WILMINGTON TECHNICAL REVIEW COMMITTEE, STORMWATER AND TREE SPECIAL RE-EXAMINATION	11/19/2021
7	PROGRESS SET	11/19/2021
8	NEW HANOVER COUNTY ZONING AND EROSION CONTROL RE-EXAMINATION	06/24/2021
9	NEW HANOVER COUNTY ZONING AND EROSION CONTROL RE-EXAMINATION	06/24/2021
10	CITY OF WILMINGTON TECHNICAL REVIEW COMMITTEE SUBMITTAL	07/27/2020

SCALE
FINAL DRAWING FOR REVIEW ONLY
 8/2/03/2022

SCALE

243 North Front Street
 Wilmington, North Carolina 28401
 Phone: (910)343-1048, Fax: (910)251-4282
 License: F-1222
 www.mckimcreed.com

CENTERPOINT PARTNERS OF WILMINGTON
 320 BROAD STREET, SUITE 600
 CHARLESTON, SC 29401

CENTERPOINT EASTWOOD ROAD TREE INVENTORY
 TOWNSHIP OF WILMINGTON, NEW HANOVER COUNTY, NORTH CAROLINA

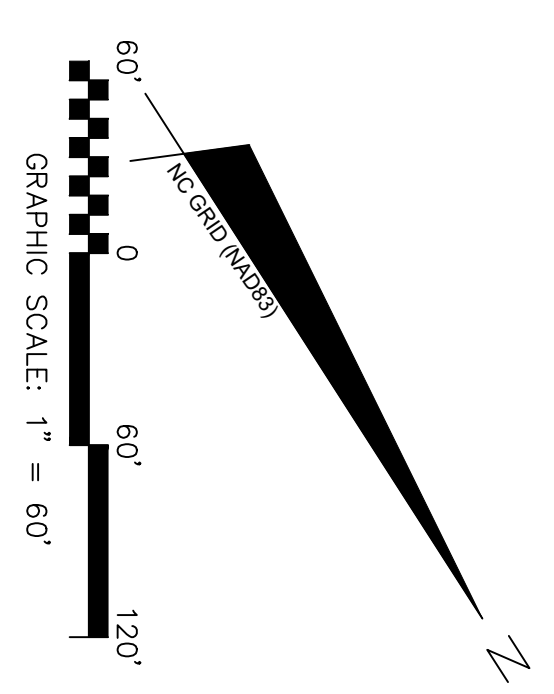

1 LEGEND AND NOTES

DATE:	04/28/2022	SCALE:	AS SHOWN
DRAWN BY:	EMAMDH	HORIZONTAL SCALE:	1" = 60'
DESIGNED BY:	EMAMDH	VERTICAL SCALE:	N/A
CHECKED BY:	KCEE		
PROJECT MANAGER:	KCEE		

STATUS: **PRELIMINARY DESIGN**
 NOT FOR CONSTRUCTION

LEGEND

- 50' CONSERVATION RESOURCE
- VEGETATIVE BUFFER
- CITY OF WILMINGTON CONSERVATION RESOURCE SETBACK LINE
- EXISTING PIPE TO BE REMOVED
- WETLANDS (404 OR 401)
- STRUCTURE TO BE REMOVED
- PAVING TO BE REMOVED
- PINE
- GUM MAPLE/OAK
- TREE TO BE REMOVED

DEMOLITION NOTES:

- TREE COUNT ABOVE REFLECTS THE SURVEY TREES AS ILLUSTRATED ON THE PLANS WITHIN THE PROJECT LIMITS.
- REFERENCE TREE LIST TABLE DOCUMENT FOR A COMPLETE LIST OF TREES SPECIES AND CALIPER SIZES.
- SHOULD ANY DAMAGE OCCUR TO EXISTING UTILITIES, IT SHALL BE REPAIRED SOLELY AT THE CONTRACTOR'S EXPENSE.
- THE CONTRACTOR SHALL VERIFY EXISTING INVERTS PRIOR TO CONSTRUCTION OF UNDERGROUND UTILITIES. TEST FITTING OF COORDINATES WITH THE OWNER.
- IF NECESSARY, SHALL BE THE CONTRACTOR SHALL NOTIFY NEW HANOVER COUNTY AT LEAST TWO (2) WEEKS PRIOR TO THE START OF CONSTRUCTION AND SHALL COORDINATE ALL MATERIALS AND METHODS OF CONSTRUCTION SHALL CONFORM TO ALL DRAWINGS, PROJECT SPECIFICATIONS, AND LOCAL BUILDING CODES.
- ANY PROPERTY LINE MONUMENTATION DISTURBED DURING CONSTRUCTION SHALL BE REPLACED SOLELY AT THE CONTRACTOR'S EXPENSE.
- ALL TREES OUTSIDE THE LIMITS OF DISTURBANCE, WHETHER CLASSIFIED AS PROTECTED OR NON-PROTECTED SHALL REMAIN UNDISTURBED.
- NO EARTH DISTURBING ACTIVITIES SHALL COMMENCE UNTIL ALL PERIMETER EROSION CONTROL MEASURES ARE IN PLACE IN ACCORDANCE WITH THE EROSION CONTROL SEQUENCE SHOWN IN THESE PLANS.
- THE CONTRACTOR SHALL ASSUME RESPONSIBILITY FOR THE PROTECTION OF ALL EXISTING UTILITIES, AND SHALL HAVE ALL UTILITIES EXPERTS VERIFY AND MARK UTILITIES WHICH ARE DISTURBED BY CONSTRUCTION ACTIVITIES.
- CONTRACTOR IS RESPONSIBLE FOR REPAIRS OF DAMAGE TO ANY EXISTING IMPROVEMENTS, AT HIS EXPENSE, DURING CONSTRUCTION, SUCH AS, BUT NOT LIMITED TO, DRAINAGE, UTILITIES, PAVEMENT, STRIPING, CURB, ETC. REPAIRS SHALL BE EQUAL TO OR BETTER THAN EXISTING CONDITIONS.
- CONTRACTOR SHALL COMPLY TO THE FULLEST EXTENT WITH ALL REGULATIONS GOVERNING THE DEMOLITION, REMOVAL, STORAGE, AND DISPOSAL OF ALL DEBRIS.
- CONTRACTOR SHALL COMPLY TO THE FULLEST EXTENT WITH THE LATEST OSHA STANDARDS FOR EXCAVATION AND TRENCHING PROCEDURES. CONTRACTOR SHALL USE SUPPORT SYSTEMS, SLOPING, BENCHING, ETC. AS NECESSARY FOR THESE OPERATIONS, AND SHALL COMPLY WITH ALL OSHA PERFORMANCE CRITERIA. CONTRACTOR SHALL TAKE SPECIAL CARE TO PROTECT ALL UTILITIES AND APURTANCES TO REMAIN.



NEW HANOVER COUNTY

ENGINEERING

230 Government Center Drive, Suite 160, Wilmington, NC 28403

P: (910) 798-7139 | F: (910) 798-7051 | NHCgov.com

Jim Iannucci, PE, CFM, County Engineer

February 17, 2022

Centre Point, LLC
1131-B Military Cutoff Road,
Wilmington, North Carolina 28405

RE: Grading Permit #21-21, CenterPoint Development

Dear Mr. Jason Swain:

This office has reviewed the erosion and sedimentation control plan. We find the plan to be acceptable and hereby issue this land-disturbing permit. **Please read the permit conditions carefully, return the signed blue original to our office and keep the copy for your records.** A copy of the enclosed land-disturbing permit must be posted at the job site. This letter gives the notice required by GS 113A-61.1(a) and the New Hanover County Erosion and Sedimentation Control Ordinance Article VIII Section 8.21 of our right of periodic inspection to ensure compliance with the approved plan.

As of April 1, 2019, all new construction activities are required to complete and submit an electronic Notice of Intent (eNOI) form requesting a Certificate of Coverage (COC) under the NCG010000 Construction General Permit. The COC **must** be obtained **prior** to the commencement of any land-disturbing activity on the above-named project, according to State Stormwater requirements. The NOI form may be accessed at deq.nc.gov/NCG01. Please direct questions about the NOI form to Paul Clark at Paul.clark@ncdenr.gov. After you submit a complete and correct NOI Form, you will receive a link with payment instructions for the \$100 annual permit fee. After the fee is received, you will receive the COC via email. The \$100 fee will be charged annually until the project receives a final land-disturbance inspection. Once the project is stabilized and receives the final land-disturbance inspection, you should file a Notice of Termination (NOT) with the State to final out the project.

A copy of the enclosed land-disturbing permit, a copy of the approved erosion and sedimentation control plan as well as any approved deviations, records of inspections made during the previous 12 months with the States Certificate of Compliance (COC) number on the reports, and a rain gauge must be posted at the job site as required by 15A NCAC 4B .0118(a), the NCG01 permit, and the New Hanover County Erosion and Sedimentation Control Ordinance Article VIII Section 8.19(o).

The land disturbing fee of **\$6099** is due to be paid to Beth Wetherill's attention in Engineering, prior to issuance of any Certificate of Occupancy or Certificate of Completion.

A preconstruction meeting is optional prior to land-disturbing activity on this project. Please contact me at (910) 798-7139 if you would like to schedule this meeting in our office. If you choose not to have a preconstruction meeting, **you must contact us with the date the land-disturbing activity will take place onsite and again once the initial erosion control measures are installed.**

New Hanover County's Erosion and Sedimentation Control Program is performance-oriented, requiring protection of existing natural resources and adjoining properties. If, following the commencement of this project, it is determined that the erosion and sedimentation control plan is inadequate to meet the requirements of the Sedimentation Pollution Control Act of 1973 (North Carolina General Statutes 113A-51 through 66), and the New Hanover County Erosion and Sedimentation Control Ordinance Article VIII Section 8.19 (f), this office may require revisions to the plan and its implementation of the revisions to ensure compliance with the Act and Ordinance.

This land-disturbing permit will expire within 1 year following the date of approval, if no land-disturbing activity has been undertaken, as required by the New Hanover County Erosion and Sedimentation Control Ordinance Article VIII Section 8.18 (d). If no activity takes place within one year after work has begun onsite, the permit will expire. Please contact this office to reactivate a permit that has expired.

Acceptance and approval of this erosion control plan is conditioned upon your compliance with Federal and State water quality laws, regulations and rules and local city or county ordinances or rules. This land-disturbing permit approval does not supersede any other permits or approvals. It is the owner's responsibility to have all the permits and approvals that are required, prior to beginning construction.

Please note this approval is based in part on the accuracy of the information provided in the Financially Responsibility Form, which you provided. You are required to file an amended form if there is any change in the information included on the form.

Your cooperation is appreciated,

Beth E. Wetherill C.P.E.S.C.
Erosion Control Specialist

Enclosures: Land-Disturbing Permit
NPDES NCG01 Fact Sheet and Monitoring Form

cc: Brian Chambers Senior Planner City of Wilmington
Kathryn Espinoza PE, McKim & Creed



Permit GP #21-21

Permit for a Land-Disturbing Activity

New Hanover County
Department of Engineering
230 Government Center Drive - Suite 160
Wilmington, North Carolina 28403
(910) 798-7139

As authorized by the New Hanover County Erosion and Sedimentation Control Ordinance

This permit issued to Centre Point, LLC authorizes the development of 20.33 acres of land at 1521 Eastwood Road for the CenterPoint Development in New Hanover County. This permit issued on February 17, 2022, is subject to compliance with the application and site drawings, all applicable regulations and special conditions and notes set forth below. **Any plan modifications must be approved by this office prior to field changes.**

It is understood by the applicant that a representative of New Hanover County's Engineering Department may inspect the site at any time following the issuance of this Permit. A copy of the approved Soil Erosion Control Plan as well as any approved deviations, this permit, a rain gauge, the Certificate of Coverage (COC) number from the State and copies of the Combined Self-Monitoring and Self-Inspection Reports must be available at all times at the site.

Failure to execute the provisions of this permit and the approved Soil Erosion Plan, or any other provisions of the New Hanover County Soil Erosion and Sedimentation Control Ordinance, may result in immediate legal action by the County to the limits prescribed by the Ordinance. If the measures outlined on the approved Soil Erosion Control Plan and this Permit prove insufficient, additional Erosion Control measures can and will be required which in turn will be considered provisions of this Permit. This Permit does not preclude any other permits or approvals necessary for beginning or completing this development. Approval of an erosion control plan is conditioned on the applicant's compliance with Federal and State laws, regulations, and rules. It is the Permittee's responsibility to obtain all necessary permits and approvals and to ensure the information given for this permit is accurate and updated if ownership or the financially responsible party changes.

SPECIAL CONDITIONS

(THESE CONDITIONS MUST BE FOLLOWED IN ADDITION TO THE PLANS AND SPECIFICATIONS)

*All the soil erosion control measures will be installed as the site is cleared and maintained throughout construction. This project includes 3 Phases of construction with specific construction sequences for each phase. Erosion control measures include 3 construction entrances, silt fences, silt fence outlets, a temporary ditch crossing, 2 impervious dikes and a pump around system with silt bags and all drainage onto stable surfaces during removal of the existing pipes, removal of the temporary ditch crossing, stream improvements associated with the culvert installation and during culvert installation, installation of jute lining on bare areas on either end of the culvert, installation of 18-inch wattle check dams in the stream, inlet and outlet protection, and 18 inch wattle flume protection on Calypso Drive. Note: If work onsite begins prior to installation of the NCDOT road and drainage improvements. The clearing adjacent to the stream may need to be limited and erosion control measures revised in order to protect the stream. Additional plans may be required for these activities. Flocculants may be required if turbidity exceeds 25 NTU's.

**Note the required separate NCG01 permit that requires concrete washouts and other NCG01 regulations.

*In issuing this permit New Hanover County has relied on the representations of the permit applicant. The county has no jurisdiction to determine any contested property rights or ownership.

***Tree Removal Permits and/or Approvals are required from the City of Wilmington and/or New Hanover County PRIOR to clearing of the site.**

*Silt fence stakes must be steel and will be placed **six feet apart without wire reinforcement** or **eight feet apart with wire reinforcement**. Silt fence is **not** allowed as inlet protection.

**Note the NCG01 permit requires concrete washouts and other regulations.

*In issuing this permit New Hanover County has relied on the representations of the permit applicant. The county has no jurisdiction to determine any contested property rights or ownership.

***Tree Removal Permits and/or Approvals are required from the City of Wilmington and/or New Hanover County PRIOR to clearing of the site.**

*Silt fence stakes must be steel and will be placed **six feet apart without wire reinforcement** or **eight feet apart with wire reinforcement**. Silt fence is **not** allowed as inlet protection.

*This permit does not preclude any permits or approvals which may be necessary including but not limited to the City of Wilmington, New Hanover County, NC DEMLR, C.A.M.A., the US Army Corps. of Engineers, DEM Solid Waste, any other agency or any approvals that may be necessary.

*No sediment shall leave the site in suspension of water.

*If plan revisions are necessary, you must submit a copy to this office for approval **prior** to any field changes.

*If soil is brought onto this site or removed from this site, it must come from or be taken to an approved or permitted site, to be identified to this office **prior** to being brought onsite or removal from the site.

*All City and/or County and State drainage and stormwater requirements will be adhered to.

*If these measures fail to adequately control erosion, more restrictive measures will be required.

*If any phase of grading ceases for more than 90 calendar days following completion of construction or development the site will be stabilized.

*All slopes must be stabilized within 21 calendar days of completion of any phase of activity.

The approval of an erosion control plan is conditioned on the applicant's compliance with Federal and State Water Quality laws, regulations, and rules.

*Note the required rates for seed, lime, fertilizer, and mulch in your seeding specifications.

***Enclosed is a Combined Self-Monitoring and Self-Inspection Form that meets the requirements of both the NPDES Stormwater Permit for Construction Activities, NCG 010000 reporting and the Land Resources Self-Inspection Program that satisfies the requirements of the Sedimentation Pollution Control Act. These are mentioned below with specific requirements for each program. These reports are the responsibility of the property owner. They require a rain gauge onsite, inspections and reporting every 7 calendar days and within 24 hours of every 1.0-inch rain per 24-hour period and at specific phases of construction. Additional copies of this Combined Construction Inspection Report can be found at <http://portal.ncdenr.org/web/lr/erosion> .**

Reports must be available onsite at all times. If you have questions, please contact New Hanover County Engineering (910) 798-7139 or the Land Quality Section at the NC DEMLR Regional office at (910) 796-7215.

***Note the NPDES information from the State for sites disturbing 1 acre or more and the reporting requirements.** All **NEW** projects permitted after August 3, 2011, **must include** the following surface water withdrawal locations and stabilization requirement designations on the plan in order to qualify for coverage under the most recent NPDES Construction General Permit. All settling basins must have outlet structures that withdraw water from the surface, with the exception of basins or traps that have a drainage area of less than 1 acre. The NPDES permit also requires ground cover within 15 calendar days on disturbed flat areas and ground cover within 7 calendar days on all areas within HQW Zones, perimeter dikes, swales, ditches, perimeter slopes and all slopes steeper than 3:1. Exceptions include slopes that are 10 feet or less in length and not steeper than 2:1 which must be stabilized within 14 calendar days and slopes greater than 50 feet which must be stabilized within 7 calendar days. It requires inspections of all erosion control measures and reporting every 7 days and within 24 hours of every 1.0-inch rain event in a 24-hour period. This permit also includes other new

requirements which are listed in the text of the NPDES Stormwater Discharge Permit for Construction Activities, which is included with the original copy of each land-disturbing permit.

***All construction activities are required to complete and submit an electronic Notice of Intent (eNOI) form requesting a Certificate of Coverage (COC) under the NCG010000 Construction General Permit.** The COC must be obtained prior to the commencement of any land- disturbing activity on the above-named project, according to State Stormwater requirements. The NOI form may be accessed at deq.nc.gov/NCG01. Please direct questions about the NOI form to Paul Clark at Paul.clark@ncdddenr.gov. After you submit a complete and correct NOI Form, you will receive a link with payment instructions for the \$100 annual permit fee. After the fee is received, you will receive the COC via email. The \$100 fee will be charged annually until the project receives a final land-disturbance inspection. Once the project is stabilized and receives the final land-disturbance inspection, you should file a Notice of Termination (NOT) with the State to final out the project.

***Note the Land Resources Self Inspection Program Requirements. This program is separate from the NPDES reporting and requires inspection and documentation after each phase of construction. These phases include: Installation of perimeter erosion control measures, Clearing and Grubbing of existing ground cover, Completion of any phase of grading of slopes or fills, Installation of storm drainage facilities, Completion of construction or development, Establishment of permanent ground cover sufficient to restrain erosion and any Deviation from the approved plan.**

***Pre-construction meetings are optional. Contact Beth E. Wetherill at (910) 798-7139 to set up a meeting prior to land-disturbing activity onsite. If you do not choose to have a preconstruction meeting prior to starting work on site, you should contact us when activity begins and again when the initial measures have been installed.**

This Permit will expire one year from date of issue if no construction activity begins on site. This permit may not be amended or transferred to another party without approval of this office.

Acknowledgment of receipt of Permit

Owner

By (please print)

Signature

Beth E. Wetherill

Beth E. Wetherill, C.P.E.S.C.
Soil Erosion Specialist/New Hanover County